

## Toggle Switches

(continued)

1823.1101

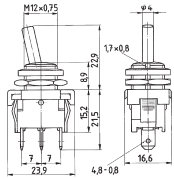

1824.1101

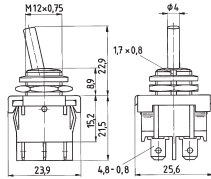

MARQUARDT

Part No.	Description
1823.1101	SPDT, 6(4)A/250V, Faston 4,8mm, $\phi$ 12,2mm, ON-OFF
1824.1101	DPDT, 6(4)A/250V, Faston 4,8mm, $\phi$ 12,2mm, ON-OFF

Part No.	Ord. No.
S 1823.1101	459
S 1824.1101	461

343.001.023



Neopren® - cap for dust and water protection of the actuator side, for MARQ 1823, 1824 series, height 18mm.

MARQUARDT

Part No.	Ord. No.
S 343.001.023	828

## Various Rocker Switches

### 19x13 mm Series

ECONOMIC

MRS-101-C2



MRS-101-C3



MRS-112-C2



Part No.	Description
MRS-101-C2	1-pole, 6A/250V, black, ON-OFF
MRS-101-C3	1-pole, 3A/250V, black, I/O, ON-OFF
MRS-112-C2	1-pole, 3A/250V, black, ON-MOM

Part No.	Ord. No.
S MRS-101-C2	57197
S MRS-101-C3	46622
S MRS-112-C2	46627

MRS-201-3



MRS-201-C3



DS 850 LED



MIYAMA

Part No.	Description
MRS-201-3	2-poles, 3A/250V, black, ON-OFF
MRS-201-C3	2-poles, 3A/250V, glim-lamp backlight, ON-OFF
DS 850 LED	1-pole 3A/250V, soldering eyelets, LED (red, green), ON-OFF

Part No.	Ord. No.	Colour
S MRS-201-3	46619	-
S MRS-201-C3	46629	red

Part No.	Ord. No.	Colour
S DS 850 LED RED	28255	red
S DS 850 LED GREEN	28256	green

MRS-103-C6



MRS-203-3C6



Part No.	Description
MRS-103-C6	1-pole, ON-OFF-ON, 3A/250V, black
MRS-203-3C6	2-poles, ON-OFF-ON, 3A/250V, black

Part No.	Ord. No.
S MRS-103-C6	46621
S MRS-203-3C6	46624

## 19x22 mm Series

H8650 VB01

Arcolectric

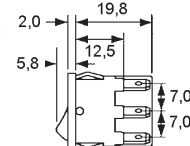

Part No.	Description
H 8650 VB01	2-poles, 10(4)A/250V, Faston 4,8mm, ON-OFF

Part No.	Ord. No.
S H 8650 VB01	2891

## 28x11 mm Series

ECONOMIC

IRS-101-1A3



Part No.	Description
IRS-101-1A3	1-pole, 15A/250V, glim-lamp backlight, ON-OFF

Part No.	Ord. No.
S IRS-101-1A3	49875

## 28x22 mm Series

ECONOMIC

RS-201-1A3



IRS-201-1A3



RS-203-1A6



Part No.	Description
RS-201-1A3	2-pole, 15A/250V, non backlight, ON-OFF
IRS-201-1A3	2-pole, 15A/250V, glim-lamp backlight, ON-OFF
RS-203-1A6	2-pole, 15A/250V, red, ON-OFF-ON

Part No.	Ord. No.
S RS-201-1A3	46615
S IRS-201-1A3	46605
S RS-203-1A6	45906

IRS-201-E-1C



RS-2101-1C3



Part No.	Description
IRS-201-E-1C	2x1-pole, 15A/250V, black, glim-lamp backlight, ON-OFF
RS-2101-1C3	2x1-pole, 15A/250V, red, ON-OFF

Part No.	Ord. No.
S IRS-201-E-1C	46606
S RS-2101-1C3	46614